

P/N: 3A6251A
 SALES KIT, MACRO, MICRO USB, 6 BUTTON
 INCLUDING:
 1 3A6252A TRANSMITTER
 1 3A6253A RECEIVER

FOR FCC, ICC, AND CE DECLARATIONS AND
 OTHER INFORMATION, SEE
[HTTP://KAR-TECH.COM/CERTIFICATION](http://kar-tech.com/certification)

This device complies with Part 15 of the FCC Rules. Operation is subject to the following two conditions: (1) this device may not cause harmful interference, and (2) this device must accept any interference received, including interference that may cause undesired operation. Changes or modifications not expressly approved by Kar-Tech will void the user's authority to operate the equipment.

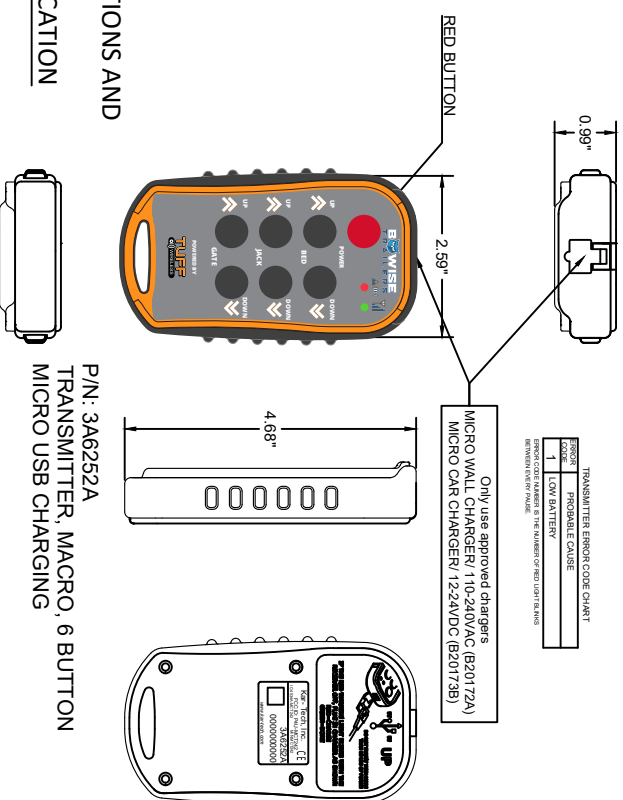

Only use approved chargers
 MICRO WALL CHARGER/ 110-240VAC (B20172A)
 MICRO CAR CHARGER/ 12-24VDC (B20173B)

ERROR CODE	PROBABLE CAUSE
1	LOW BATTERY

ERROR CODE NUMBER IS THE NUMBER OF RED LIGHTS WHEN INDICATOR CODES ARE FLASHING

P/N: 3A6252A
 TRANSMITTER, MACRO, 6 BUTTON
 MICRO USB CHARGING

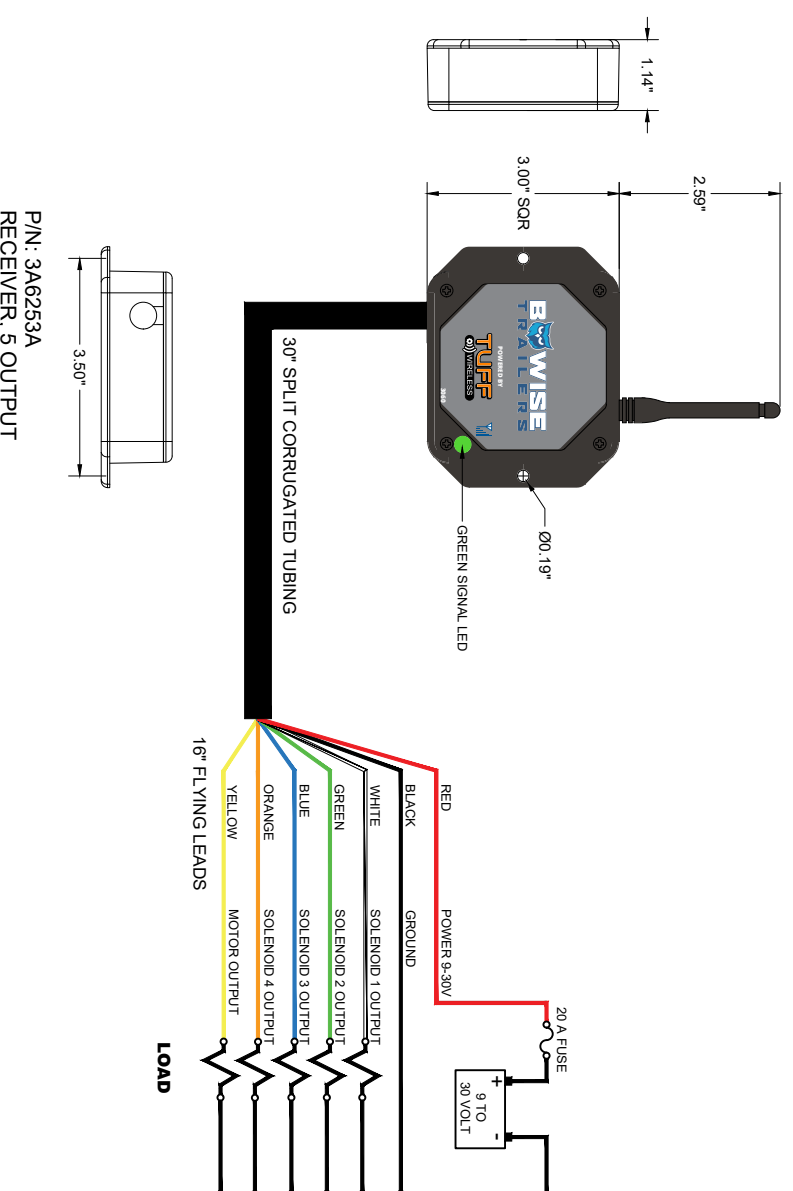

P/N: 3A6253A
 RECEIVER, 5 OUTPUT

OPERATION

To turn on the transmitter, press and hold the POWER button for at least 2 seconds and release. To turn the transmitter off, press and hold the POWER button until the LEDs turn off. The transmitter is designed with a power saving feature which turns the transmitter off after 15 minutes if no buttons are pressed. There are red and green LEDs both on the keypad of the transmitter and inside the receiver case. The green LED will blink rapidly when the transmitter and receiver are communicating. It will blink slowly if there is no communication (i.e., - no power to the receiver). The transmitter's red LED blinks 1 time per second if the battery is low and needs to be charged. The red LED will stay on while charging and when the charge is completed the green LED will stay on. It will take longer to charge if the transmitter is on during charging. Transmitter and Receiver Green LEDs will turn solid for 1 second upon power up.

SYNCHRONIZING TRANSMITTER AND RECEIVER

- Each transmitter and receiver pair is synchronized together at the factory. If a new transmitter is needed, synchronizing is required. Use the following procedure:
1. Make sure both the transmitter and receiver are off.
 2. Press and hold the POWER button on the transmitter for more than 10 seconds. The red and green LED will start to blink.
 3. Apply power to the receiver
 4. Wait for a few seconds until only the green LED begins to blink on the transmitter
 5. Teach complete

SLEEP TIME

- All transmitters have the ability to change the sleep time from the default to user's preference. The transmitter is factory set to turn off (sleep) after 15 minutes. To change the time the transmitter waits before going to sleep, use the following procedure:
1. With the transmitter off, press and hold buttons BED UP, BED DOWN, and POWER
 2. Keep holding the buttons for a few seconds then release the buttons. At this point, both lights will blink once per second
 3. On the transmitter, press one of the following buttons to adjust the sleep time:
 - a. BED UP=15 minutes
 - b. BED DOWN=30 minutes
 - c. JACK UP=1 hour
 - d. JACK DOWN=2 hours
 - e. GATE DOWN=sleep disabled
 4. Sleep time programming complete

CLONING TRANSMITTERS

WARNING! - ONLY ONE TRANSMITTER CAN BE ON AT A TIME. THEY CANNOT BE USED SIMULTANEOUSLY - use with CAUTION! Occasionally, it is desirable to have more than one transmitter work with a single receiver. This is accomplished by a process called cloning. Cloning allows an additional transmitter (B) to have the same ID code as the original transmitter (A). If this feature is desired, use the following procedure:

1. Make sure both transmitters and the receiver are off
 2. On Transmitter A, press and hold the POWER button for 10 seconds until LEDs blink, then release. Green and red LEDs will blink together at this point
 3. On Transmitter B, press and hold buttons JACK UP, GATE DOWN, and POWER simultaneously until both LEDs start to blink
 4. Wait for few seconds until the green LED starts to blink on both transmitter A and transmitter B.
 5. Turn both the transmitters off
 6. Synchronize one of the transmitters to the receiver using SYNCHRONIZING TRANSMITTER AND RECEIVER instructions above
- If the cloning feature has been invoked and is no longer desired, the ID code of one of the transmitters needs to be changed. This will undo the transmitters. If this is desired, use the following procedure:
1. Make sure the receiver and transmitter are OFF
 2. Press and hold buttons JACK UP, JACK DOWN, GATE UP, and POWER buttons simultaneously until both LEDs start toggling then release
 3. Press any button again to select a new ID
 4. Undoing complete
 5. Follow the SYNCHRONIZING TRANSMITTER AND RECEIVER procedure above to link the uncloned transmitter to a new receiver

SPECIFICATIONS:

- Electrical:
 RF Transmitt power (EIRP): 100 Mw
 RF Frequency: 2.4GHz
 Transmitter:
 Power: Rechargeable 3.7V/Lithium Polymer battery
 Operation time with full charge: 30 to 40 hours continuous
 Receiver:
 Power: 9 to 30 Volts DC
 Outputs: 5A max each (20A system max)
 Environmental:
 Transmitter: -20°C to +60°C
 Receiver: -40°C to +85°C

BUTTON PRESSED	OUTPUT BEHAVIOR				
	MOTOR	SOLENOID 1	SOLENOID 2	SOLENOID 3	SOLENOID 4
HOIST/BED UP	X				
HOIST/BED DOWN	X	X			
TONGUE/JACK UP	X		X	X	
TONGUE JACK DOWN	X	X		X	
GATE EXTEND	X		X		X
GATE RETRACT	X	X			X